

Mattress holder - way of assembly

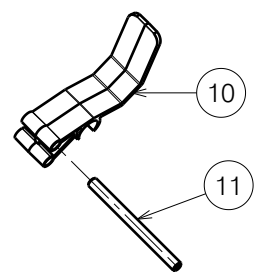

EP00261 / M

HEAD SIDE WITH LATHS ILLICO				Plan No.
				1/2 EP00261 / M
Scale: 1:10	Drafted	Verified	Confirmed	
Date	31/10/2017	06/05/2024	06/05/2024	
Initials	DB	MK	AZ	

Material			
No.	Plan	Article	Quantity
1#	YP08882	2629303	2
2	YP06216 / Left	2784803	1
3#	YP05894	2784700	2
4	YP05898 DP	27893...	1
5	YP06173	27947...	1
6	X004563	1904874	2
7#	XP01795	2993539	2
8#	XP02992	GP22400	2
9#	XP01899	GP12700	4
10	XP01906	2993600	2
11	XP01912	2993607	2
12	XP02064	2993688	2
12**	XP01916	2993701	2
13	XP01954	2993706	2
14	Tube Cap 10x20	1001621	2
15	Nut M8 DIN 985	1001682	4
16	D8,4 DIN 125	1003199	8
17	M6x16	1008459	4
18	Nut M6 DIN 985	1001680	2
19	M6x20	1006999	2
20	M8x40 DIN 931	2993705	2
21	LA27	1901113	1
22	Pen D10x50	1998885	2
23	Tube Cap 20x20	1001612	6
24#	DIN 471 15,7-1mm	2993606	2
25	YP06448	2729800	1
26	YP06217 / Right	2795303	1
27*	Motor Cable	1912902	1
28*	Label "2" for cable	1995836	1
29	M8x45	1994473	2
30	X001842	G053400	2
31	Wheel D29	2993761	2
32	D5,3 DIN 125	1000972	4
33	Nut M5 DIN 986	1992804	2
34	M5x40	2993786	2
35#	M6x12	1007000	8

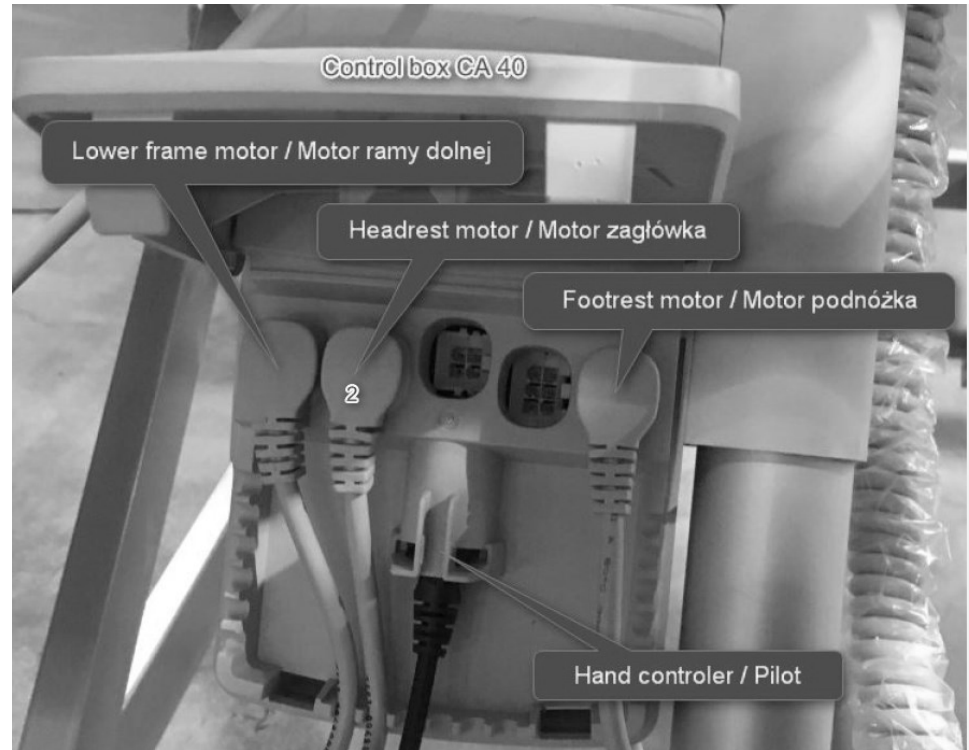

* - Not depicted.

** - Milled part, use only if 12 is unavailable.

- Use only with metal side rails (EP00256 & EP00257),

Do not use with wooden bars (EP00280) and SSR (EP00493).

' - Use W600111 on 2784700 after assembly to frame. |

EP00261 / M

HEAD SIDE WITH LATHS ILLICO				Plan No.
Scale: 1:10	Drafted	Verified	Confirmed	2/2 EP00261 / M
Date	31/10/2017	06/05/2024	06/05/2024	
Initials	DB	MK	AZ	