

NOTICE: THE INFORMATION CONTAINED ON THIS DRAWING IS PROPRIETARY TO VERMEIREN GROUP AND SHALL NOT BE DISCLOSED IN WHOLE OR IN PART, OR USED FOR ANY DESIGN OR MANUFACTURE, EXCEPT WHEN SUCH USER POSSESSES DIRECT WRITTEN AUTHORISATION FROM VERMEIREN GROUP.

Sheet 1/2

FOREST 3 / SIGMA LINX SITSMARTER			
Scale: 1:2	Drafted	Verified	Confirmed
Date	13/09/2024	05/02/2025	05/02/2025
Initials	SD	PM	MK

Plan No.

E00088423/B1.1



Detail View A (1:2)

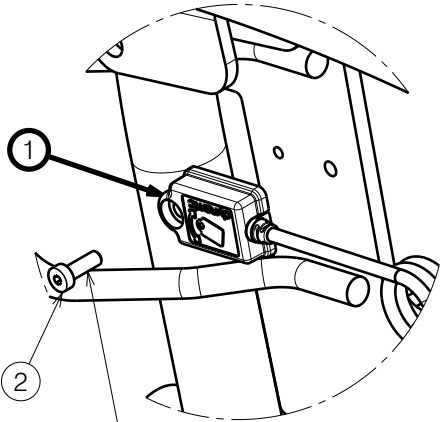

Glue with Weicon AN 302-43  
(H900009)

Detail View B (1:2)

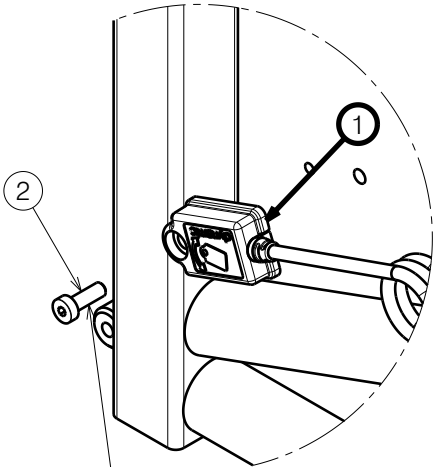

Glue with Weicon AN 302-43  
(H900009)

Detail View C (1:2)

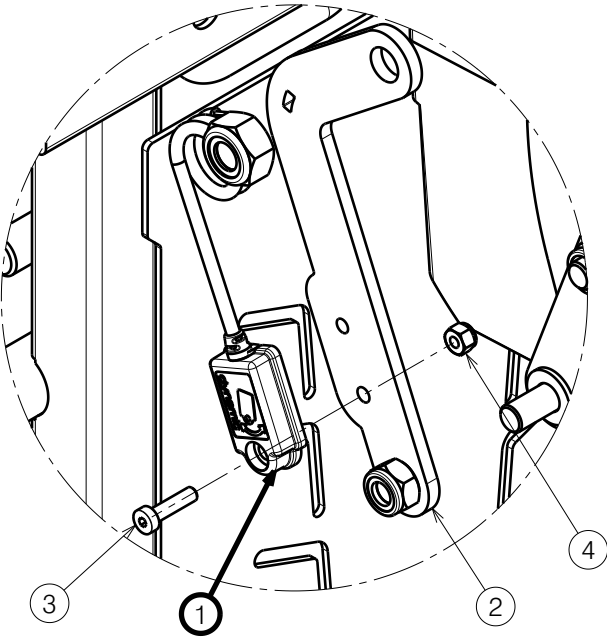

Bill of Material			
No.	Plan	Article	Quantity
1	---	1921731	1
2	M4x12 DIN7984	1907582	1

Bill of Material			
No.	Plan	Article	Quantity
1	---	1921731	1
2	M4x12 DIN7984	1907582	1

Bill of Material			
No.	Plan	Article	Quantity
1	---	1921731	1
2	M4x16 DIN7984	2994070	1
3	M4 DIN985	2994901	1

Bill of Material			
No.	Plan	Article	Quantity
1	---	1921731	1
2*	P00080978	2092854	1
3	M4x16 DIN7984	2994070	1
4	M4 DIN985	2994901	1

\* Replaces Y018419 (1777584) on one side  
(reference E001102)

Detail View D (1:2)

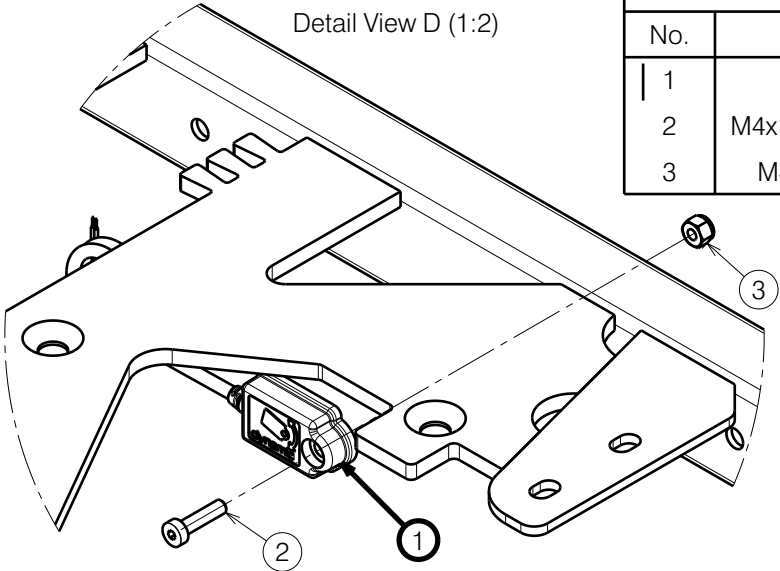

NOTICE: THE INFORMATION CONTAINED ON THIS DRAWING IS  
PROPRIETARY TO VERMEIREN GROUP AND SHALL NOT BE DISCLOSED IN  
WHOLE OR IN PART, OR USED FOR ANY DESIGN OR MANUFACTURE,  
EXCEPT WHEN SUCH USER POSSESSES DIRECT WRITTEN AUTHORISATION  
FROM VERMEIREN GROUP.

Sheet 2/2

---

FOREST 3 / SIGMA LINX SITSMARTER

Plan No.

E00088423/B1.1

Scale:	1:2	Drafted	Verified	Confirmed
Date	13/09/2024	05/02/2025	05/02/2025	
Initials	SD	PM	MK	

